

## Dados mecânicos

### Carcaças 63 a 132M/L

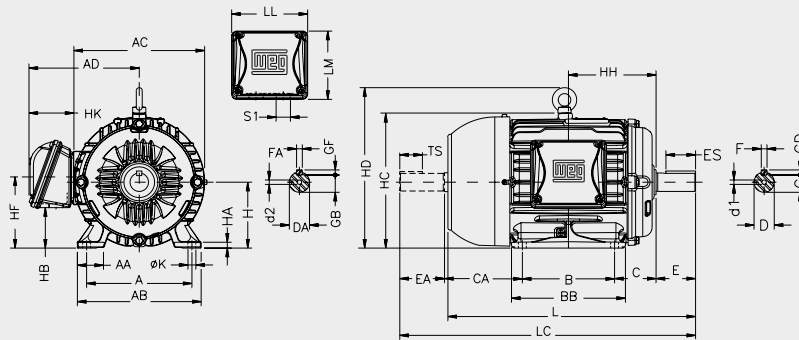

### Carcaças 160M a 200L

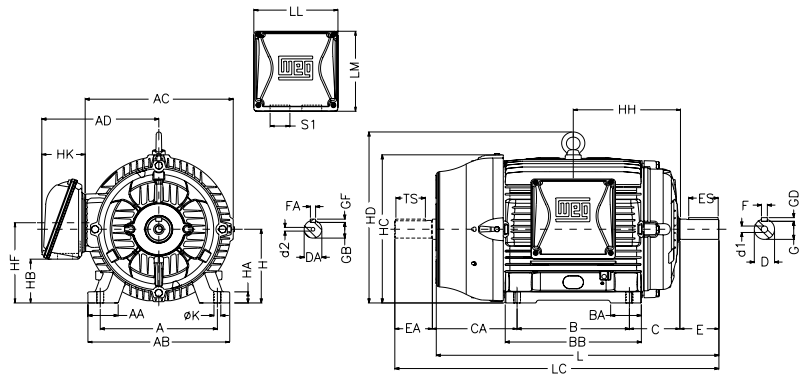

### Carcaças 225S/M a 355M/L

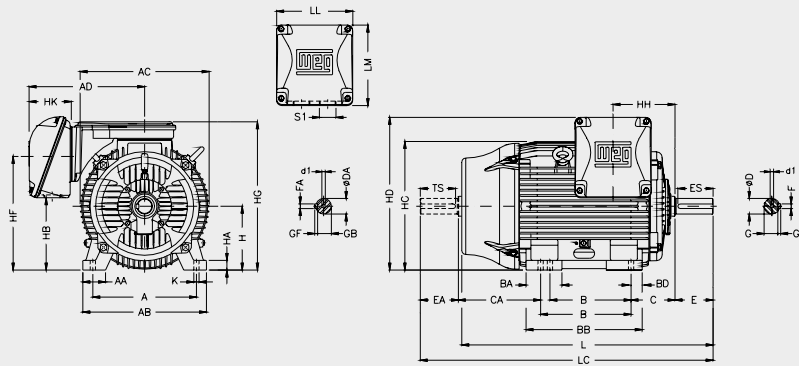

### Carcaça 355A/B

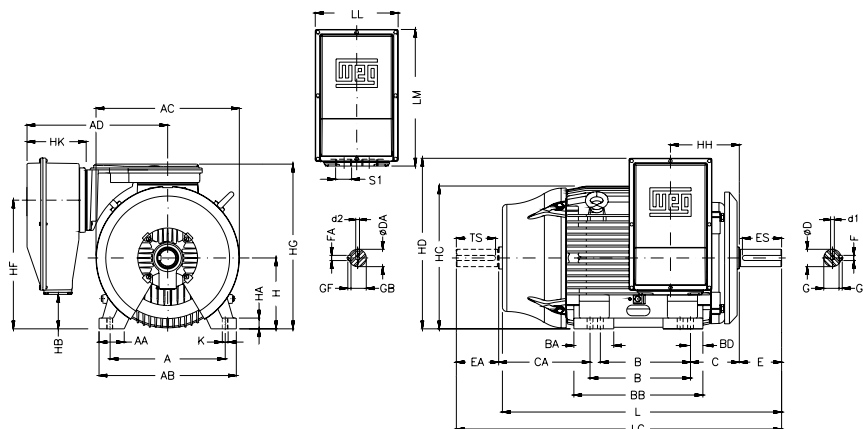

CARCAÇA	A	AA	AB	AC	AD	B	BA	BB	BD	C	CA	Ponta de eixo dianteira						Ponta de eixo traseira																											
												D	E	ES	F	G	GD	DA	EA	TS	FA	GB	GF																						
63	100	25,5	116	125	122	80		95		40	78	11j6	23	14	4	8,5	4	9j6	20	12	3	7,2	3																						
71	112	28,5	132	141	130	90		113,5		45	88	14j6	30	18	5	11	5	11j6	23	14	4	8,5	4																						
80	125	30,5	149	159	139	100		125,5		50	93	19j6	40	28	6	15,5	6	14j6	30	18	5	11	4																						
L80																																													
90S																																													
L90S																																													
90L	140	36,5	164	179	157	125		156		56	104	24j6	50	36		20		16j6	40	28		5	13	5																					
L90L																																													
100L																																													
L100L																																													
112M	160	40	188	199	167	140		173		63	118	28j6	60	45		24		22j6	50	36		6	18,5	6																					
L112M																																													
132S																																													
132M																																													
132M/L	216	51	248	271	218	140		187		89	150	38k6	80	63	10	33		28j6	60	45		8	24	7																					
132M																																													
160M																																													
160L																																													
180M	279	78	350	360	279	210		254		108	174	42k6			12	37		42k6	110	80		12	37	8																					
180L																																													
200M																																													
200L																																													
225S/M	356	80	436	455	408	286		210		149	319	55 <sub>mb</sub> *	110*	100*	16*	49*	10*	55 <sub>mb</sub> *	110*	100*	16*	49*	10*																						
250S/M																																													
280S/M																																													
315S/M																																													
355M/L	610	140	750	736	609	560		230		254	483	65 <sub>mb</sub> *	140*	125*	18*	58*	11*	60 <sub>mb</sub> *	140*	125*	18*	53*	11*																						
355A/B																																													

CARCAÇA	H	HA	HB	HC	HD	HF	HG	HH	HK	LL	LM	K	L	LC	S1	d1	d2	Rolamentos															
																		Diant.	Tras.														
63	63	7	25,5	129	68,5	76	80	59	108	98	7	216	241	RWG 1/2"	A3,15	6201-ZZ	6202-ZZ	6204-ZZ	6203-ZZ														
71	71		33	145																90													
80	80	8	43,5	163	87	100	106	118,5	67	115	104	10	325	362	RWG 3/4"	6205-ZZ	6204-ZZ																
L80	90	9	45	182	90	106	113	133	79	140	133	12	304	350	RWG 1"	A4	6206-ZZ	6205-ZZ															
90S																																	
L90S																																	
90L																																	
L90L	100	10	61,5	205	244	106,4	140	159	79	140	133	12	329	375	RWG 1"	A4	6207-ZZ	6206-ZZ															
100L																																	
L100L																																	
112M																																	
L112M	112	20	75	266	319	132	159	178	79	140	133	12	423	478	RWG 1"	A4	6308-ZZ	6207-ZZ															
132S																																	
132M																																	
132M/L																																	
160M	160	22	79	327	374	168	213	235	100	198	188	14,5	515	582	RWG 1,1/2"	6309-C3	6209-Z-C3																
160L																																	
180M																																	
180L																																	
200M	200	30	119	405	464	218	266,5	285,5	118	228	217	18,5	729	842	RWG 2"	6311-C3	6211-Z-C3																
200L																																	
225S/M																																	
250S/M																																	
280S/M	280	42	383	580	696	556	686	266	143	261	292	18,5	856*	974*	2xRWG 2"	M20	M20	6314 - C3															
315S/M																																	
355M/L																																	
355A/B																																	

(\*) Dimensão para 2 polos

(\*\*) Para 2 polos = 490 mm

(\*\*\*) Dimensão aplicável para motores com caixa de ligação no topo da carcaça

### Flange “FF”

Flange “FF”												
Carçaça	Flange	LA	M	N	P	S	T	$\alpha$	Nº de furos			
63	FF-115	9	115	95	140	10	3	45°	4			
71	FF-130		130	110	160		10					
80	FF-165	10	165	130	200	12	3,5					
90							4					
100	FF-215	11	215	180	250	15	4					
112	FF-265	12	265	230	300							
160	FF-300	18	300	250	350	19	5					
180								FF-350	350	300	400	
200	FF-400	18	400	350	450	19	5	22°30'	8			
225	FF-500		500	450	550							
250	FF-600		22	600	550					660	24	6
280												
315	FF-600	22	600	550	660	24	6					
355	FF-740									740	680	800

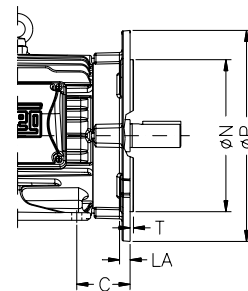
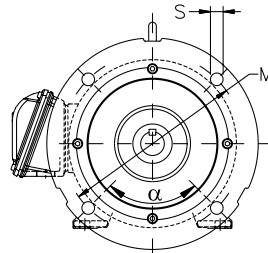

### Flange “C”

Flange “C”									
Carçaça	Flange	LA	M	N	P	S	T	$\alpha$	Nº de furos
63	FC-95	8,5	95,2	76,2	143	UNC 1/4"x20	4	45°	4
71		10							
80		15							
90	FC-149	12	149,2	114,3	165	UNC 3/8"x16	6,3		
100		13,5							
112	FC-184	9	184,2	215,9	225	UNC 1/2"x13	6,3		
132		19,5							
160	FC-228	13,5	228,6	266,7	280	UNC 5/8"x11	6,3	22°30'	8
180									
200	FC-355	18,5	355,6	406,4	455	UNC 5/8"x11	6,3		
225									
250	FC-355	18,5	355,6	406,4	455	UNC 5/8"x11	6,3		
280									
315	FC-368	33,5	368,3	419,1	455	UNC 5/8"x11	6,3		
355									

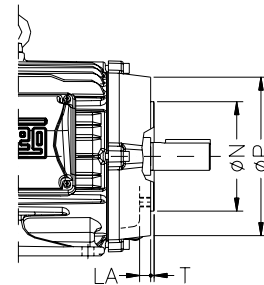
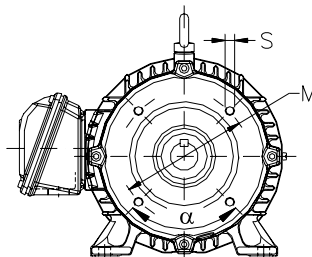

### “C-DIN” Flange

Flange “C-DIN”									
Carçaça	Flange	LA	M	N	P	S	T	$\alpha$	Nº de furos
63	C-90	9,5	75	60	90	M5	2,5	45°	4
71	C-105	8	85	70	105	M6			
80	C-120	10,5	100	80	120	M8	3		
90	C-140	12	115	95	140		3,5		
100	C-160	13,5	130	110	160	M10	3,5		
112									
132	C-200	15,5	165	130	200	M10	3,5		

